

REFUGE FLOOR PLAN (TOWER 6)
(8TH FLOOR)

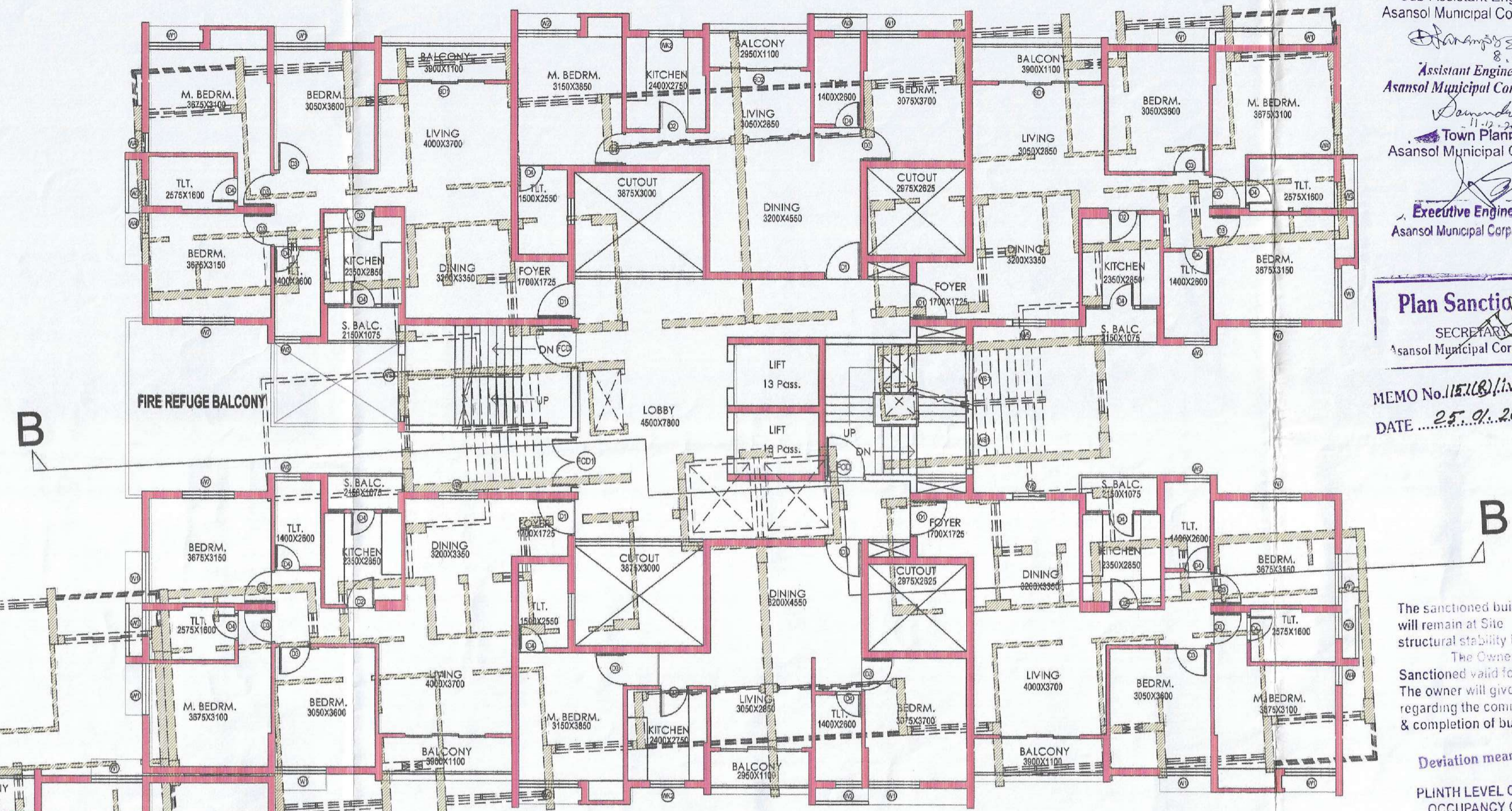

REFUGE FLOOR PLAN (TOWER 7)
(8TH FLOOR)

SCHEDULE OF DOOR

MKD.	MASONRY OPENING	
	WIDTH	HEIGHT
D1	1100	2350
D2	900	2350
D3	1000	2350
D4	800	2350
D5	1200	2350
SD1	2400	2350
SD2	2450	2350
GL1	5575	2350
GL2	4450	2350
FCD	1200	2350
FCD1	1500	2350

SCHEDULE OF WINDOW

MKD.	MASONRY OPENING		LINTEL HEIGHT
	WIDTH	HEIGHT	
W1	1550	1600	2350
W2	1800	1600	2350
W3	800	1100	2350
W4	600	1600	2350
W5	1200	1600	2350
W6	1800(LOBBY)	1600	2350
W7	1575	1100	2350
WS1	1200	1100	2350
WK1	500	1100	2350
WK2	1050	1100	2350

TOWER-6 & TOWER-7 AS MENTIONED IN REVISED DRAWING SHOULD BE TREATED AS SUPER-LUXURY BLOCK-2 NOS AS MENTIONED IN PREVIOUS SANCTIONED DRAWING VIDE MEMO NO-834/19/01 DATED 25-7-13.
Shanta Red Mittal Shashi Bhushan Singh



PROJECT- B+G+12
REVISOR 21.11.2013
Sub-Assistant Engineer
Asansol Municipal Corporation
Assistant Engineer
Asansol Municipal Corporation
Town Planner
Asansol Municipal Corporation
Executive Engineer
Asansol Municipal Corporation

Plan Sanctioned
SECRETARY
Asansol Municipal Corporation

MEMO No. 11218/11/19/01/10
DATE 25.9.2013

PROJECT- B+G+12
PROPOSED G+B+12 STORIED
RESIDENTIAL BUILDING AT PHASE-2,
SHRISTINAGAR, THAKUR ASSOCIATES
ASANSOL, THAKUR CIVIL ENGINEER
S. N. BASU, 534/1/1, JODHPUR PARK
KOLKATA-700 068
CLIENT:
BENGAL SHRISTI INFRASTRUCTURE
DEVELOPMENT LIMITED.

At Rs. Plan No-385 CP,
391 CP, 388 (D), J.L.No.18,
MOU EA- GODINDA PUR

Bengal Shristi Infrastructure Development Ltd.
Authorized Signatory/Director

SIGNATURE OF OWNER
AUTHORISED SIGNATURE OF BENGAL SHRISTI INFRASTRUCTURE DEVELOPMENT LIMITED.

CERTIFICATE OF BUILDING PLAN
I UNDERTAKE WITH FULL RESPONSIBILITY AND CERTIFY THAT THE BUILDING PLAN HAS BEEN DRAWN AS PER PROVISION OF W.B. MUNICIPAL BUILDING RULES 2007 AS AMENDED FROM TIME TO TIME AND THAT THE SITE CONDITION INCLUDING THE WIDTH OF THE ABUTTING ROAD CONFORMS WITH THE PLAN AND THAT IS A BUILDING SITE AND NOT A TANK OR FILLED UP TANK.

THAKUR ASSOCIATES
B. THAKUR (CIVIL ENGINEER)
N.S.B. ROAD
SEARSOLE RAJBARI MORE
BANGALURU
Page No. 1-1954-11-1
ANIRBAN BHADURIMONDAL
CA/2003/31394

Signature of LEA
(Name, Address and Empanment No.)
ANIRBAN BHADURIMONDAL
C.O.A. REG. NO. CA/2003/31394

CERTIFICATE OF STRUCTURAL STABILITY
THE STRUCTURAL DESIGN AND DRAWINGS OF BOTH FOUNDATION AND SUPERSTRUCTURE OF THE BUILDINGS HAS BEEN MADE BY ME CONSIDERING ALL POSSIBLE LOADS INCLUDING THE SEISMIC LOAD AS PER THE NATIONAL BUILDING CODE OF INDIA AND CERTIFIED THAT IT IS SAFE & STABLE IN ALL RESPECT.

S. N. BASU
B. E. M. STRUCT. E.M.I.C.E.
534/1/1, JODHPUR PARK
KOLKATA-700 068

Signature of Structural Engineer
(Name, Address and Empanment No.)

TITLE
BLOCK-2 & 7 [SUPER LUXURY BLOCK]
REFUGE FLOOR PLAN (8TH FLOOR)
THAKUR ASSOCIATES
B. THAKUR (CIVIL ENGINEER)
N.S.B. ROAD
SEARSOLE RAJBARI MORE
BANGALURU
DRG. NO. IN1281CORP/R-02
SCALE 1:100
DATE 07.05.16
JOB NO. IN1281
DESIGNED BY INNATE
ISSUE STATUS CORPORATION
SPECIFICATIONS
ALL DIMENSIONS ARE IN MM.
ALL EXTERNAL WALLS ARE 200 THK. AND ALL INTERNAL WALLS ARE 100 THK. BRICK WALL.
ALL P.C.C. WORK IN 1:3:6
ALL R.C.C. WORK IN 1:2:4
ALL OTHER SPECIFICATIONS CONFORMING RELEVANT I.S.I. CODE

ARCHITECT
26/2, BALL YOUNG
CIRCULAR ROAD,
UDYAN PARK, FLAT
NO-7,
3RD FLOOR, KOL-19
TEL : (033) 4000 6422/
23/24/25/26 WEBSITE
INNATE
THIS DRAWING IS A PRIVATE AND CONFIDENTIAL DOCUMENT AND IT MUST NOT BE COPIED OR LENT WITHOUT THE CONSENT OF M/S INNATE.